

PERFORMANCE DATA

MODEL PVM1 10

PVMI Vertical Multi-Stage Pumps

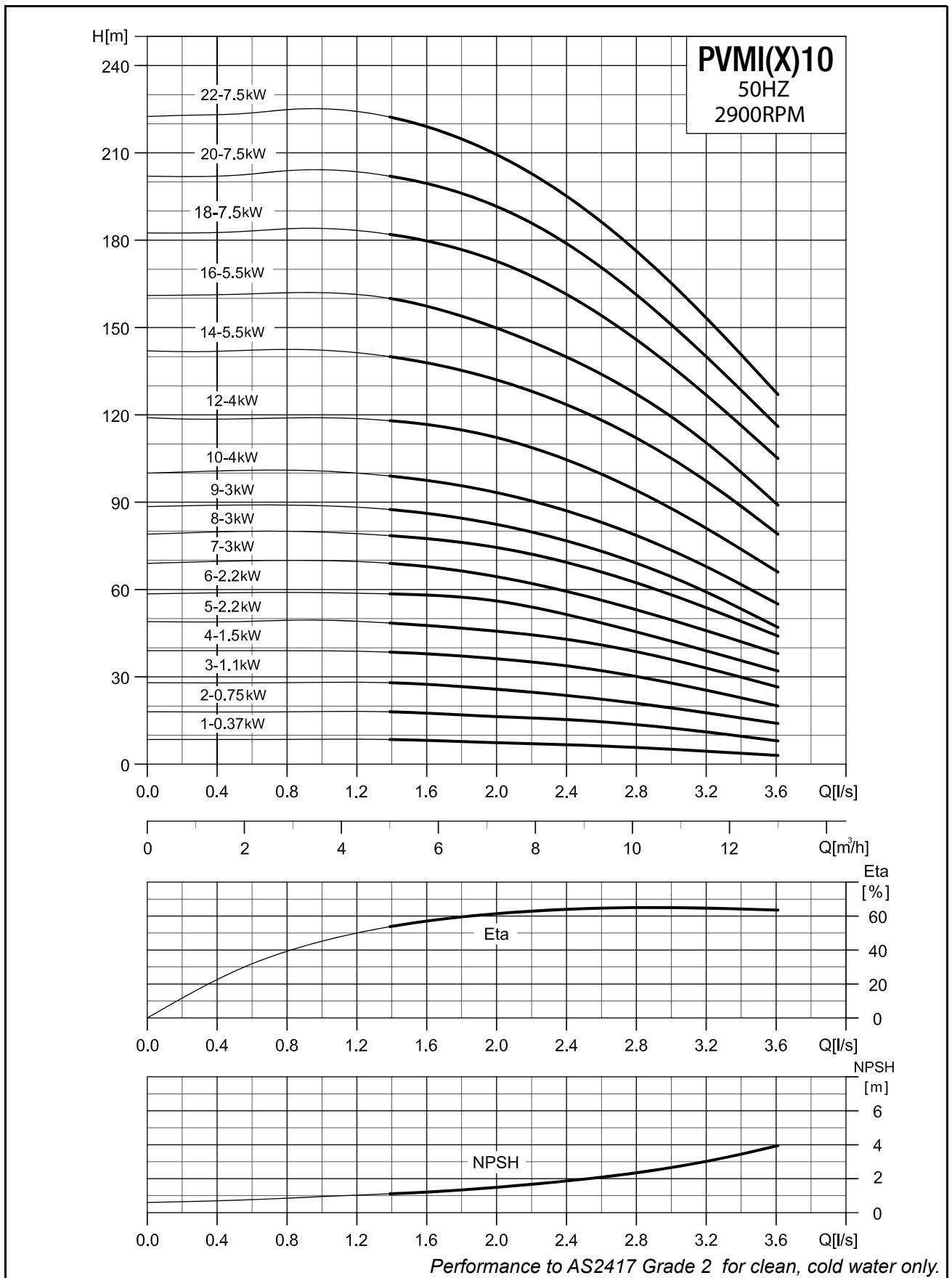

TECHNICAL DATA

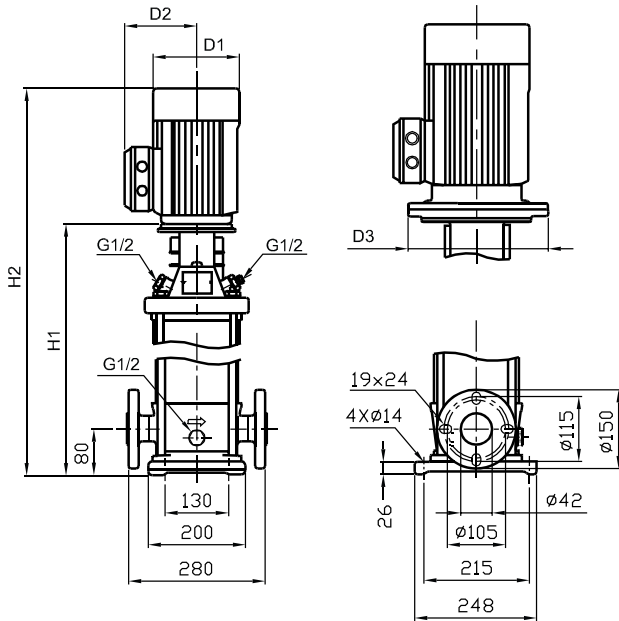

Flange (DIN - ANSI - JIS)
PN 16-25/DN40

Construction Materials		PVMI	PVMX
Motor Bracket	Ductile iron	ASTM A530 70-50-05	
Top Cap	Stainless Steel	AISI 304	AISI 316
Impeller	Stainless steel	AISI 304	AISI 316
Shaft	Stainless steel	AISI 431	AISI 316
Outer Sleeve	Stainless Steel	AISI 304	AISI 316
Outer Sleeve O Ring			EPDM
Diffuser	Stainless Steel	AISI 304	AISI 316
Neck Ring			PTFE
Base	Stainless Steel	AISI 304	AISI 316
Base plate	Cast Iron	ASTM A48 25B	
Coupling	Fe-Cu-C	MPIF FC0525	
Mechanical Seal	Cartridge Type	SiC/SiC	
Pump Range PVMI/PVMX			
Nominal Flow	10m ³ /h		
Flow Range	5 - 13m ³ /h		
Maximum Head	22 bar		
Max. Inlet Pressure	8 bar (1-6 stages) 10 bar (7-22 stages)		
Max. Operating Pressure	16 bar (1-16 stages) 25 bar (18-22 stages)		
Fluid Temperature	-15 to +120°C		
Motor			
Single Phase	220-230/240V		
Three Phase	220-240/380-415V		
Insulation	Class F		
Enclosure	IP55		
Ambient Temp	40°C		
Connections			
Flange	DIN(ISO) PN16/25 DN40 ANSI Class 300 NB40 AS2129 Table D/E NB50 AS2129 Table F/H NB40		

DIMENSIONS AND WEIGHTS (3 PHASE UNITS)							
Pump Type	Motor P2(kW)	Dimension (mm)					Net Weight (kg)
		H1	H2	D1	D2	D3	
PVMI 10-1	0.37	353	613	160	155	—	32.0
PVMI 10-2	0.75	357	617	160	155	—	34.0
PVMI 10-3	1.1	387	647	160	155	—	38.0
PVMI 10-4	1.5	433	738	175	165	—	47.1
PVMI 10-5	2.2	463	798	175	165	—	50.1
PVMI 10-6	2.2	493	828	175	165	—	51.1
PVMI 10-7	3.0	528	868	200	170	—	58.9
PVMI 10-8	3.0	558	898	200	170	—	60.0
PVMI 10-9	3.0	588	928	200	170	—	61.0
PVMI 10-10	4.0	618	1023	220	188	—	69.0
PVMI 10-12	4.0	678	1083	220	188	—	71.0
PVMI 10-14	5.5	770	1200	275	213	300	96.4
PVMI 10-16	5.5	830	1260	275	213	300	98.5
PVMI 10-18	7.5	890	1320	275	213	300	108.5
PVMI 10-20	7.5	950	1380	275	213	300	110.5
PVMI 10-22	7.5	1010	1440	275	213	300	112.6

PVMI 10 Motor Data										
Power (kW)	0.37	0.75	1.1	1.5	2.2	3.0	4.0	5.5	7.5	
In (A) 1 x 240V	2.50	4.70	6.50	8.70	12.5	16.7	—	—	—	
In (A) 3 x 415V	1.20	2.10	2.83	3.70	5.20	6.10	7.7	9.9	14.9	

Performance to AS2417 Grade 2 for clean, cold water only.