

QUICK START GUIDE

Tank Fill Pump Controller

Standard - FPC-11005

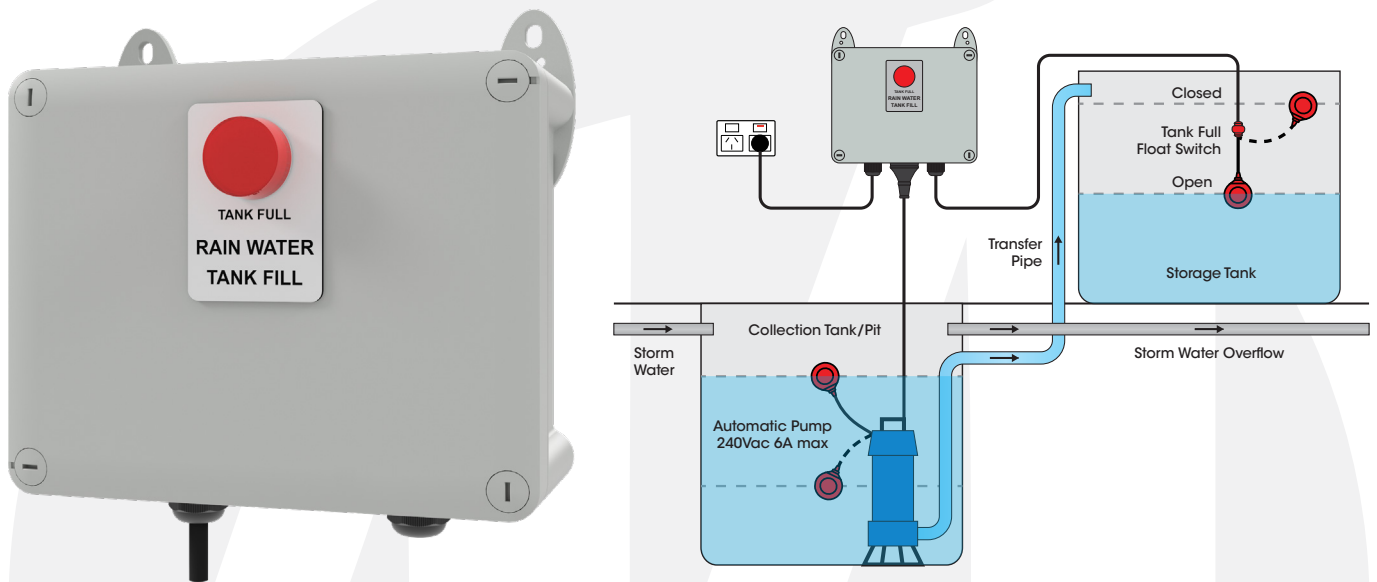

Introduction

MATElec Australia's Tank Fill Pump Controller is designed to provide power supply to an automatic pump, used to transfer water from a collection pit to a storage tank. Housed in a robust polycarbonate enclosure, the controller features a status indicator light, a GPO for power supply to the pump and a 9006 Float Switch. The controller shuts off power to the pump when storage tank is full to prevent overflowing.

Safety

This control panel has been designed and built for applications that are Commercial and/or Industrial in nature, operation, function and location. If the control panel is to be used in Domestic/Residential applications, further consideration is required by the installer to ensure its suitability. It is the responsibility of the installing electrician to ensure compliance with relevant standards.

- Prior to installation, ensure power supply is isolated.
- Electrical connection to the panel must be carried out in accordance with the following pages.
- Additions or modifications to the control panel are not permitted and will void warranty.
- The controller is not intended for use by children or infirm persons without supervision.
- Repairs to the controller must only be carried out by a suitably qualified electrician.

This operation manual makes use of the following symbols to indicate warnings that must be paid specific attention to:



Damage to equipment or personal harm may occur if this instruction is not followed



Electrical risk (electrocution hazard) may occur if this instruction is not followed

Step 1 - Installation

- Use the supplied mounting brackets to install the control panel.
- Control panel enclosure must be mounted in a vertical position.
- Ensure mounting method does not compromise enclosure weatherproof rating.
- Ensure cables/conduits entering the panel have mechanical protection and that the penetrations are sealed and do not compromise the weatherproof rating of the enclosure.

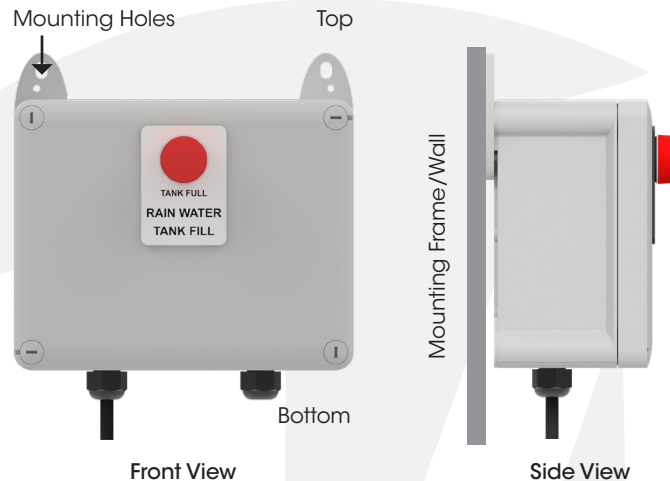

Step 2 - Float Switch Installation

- Install the float switch in the storage tank using a suitable method.
- The included float switch will be wired to close on rise, so power to the pump will be shut off when the float switch closes. Ensure the float is at the correct height in the storage tank.
- Adjust the switching differential, if required, by moving the cable weight position relative to the float switch.



Step 3 - Connections

Warning: All electrical connections must be carried out by a suitably qualified and registered electrician

- Connect the tank full float using the **brown** and **black** wires (close on rise configuration) to the input terminals.
- Connect the pump (6 Amp max) to the GPO on the underside of the panel.

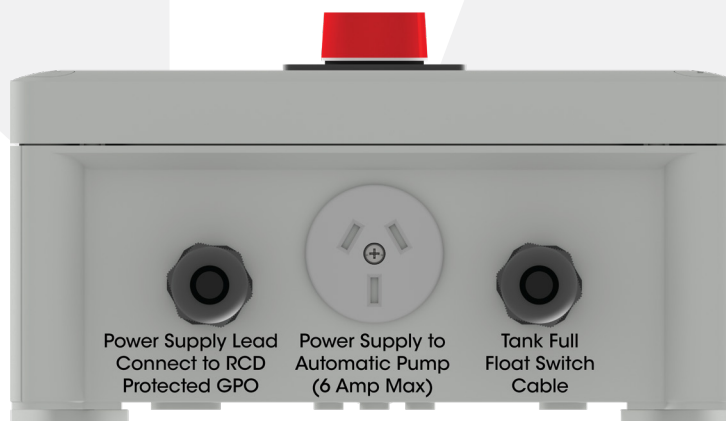

Storage Tank Full Float Switch

Step 4 - Powerup

Close and secure enclosure door, connect the power lead into RCD protected GPO and switch on mains power. The Tank Fill Pump Controller is now set up and has begun operation.