

Customer Value through Innovation



Float Valves

Apex RainAid® Valve



Apex RainAid®

The RainAid® valve is designed to be connected to the mains water supply on a rainwater collection tank.

It will provide a backup supply of water in the event of demand exceeding rain supply.



Mains Water Top Up

- Constant supply of water.

No Electricity Required

- No increase to electricity bill and simple to install.

WaterMark Approved

- Meets WaterMark standards for mains water connection.

Adjust Weight Horizontally

- Can be used with shallow tanks.

UV Stabilised

- Will continue to perform, even in harsh sunlight conditions.

Flow Rate (RA 20)

Apex RainAid Valve

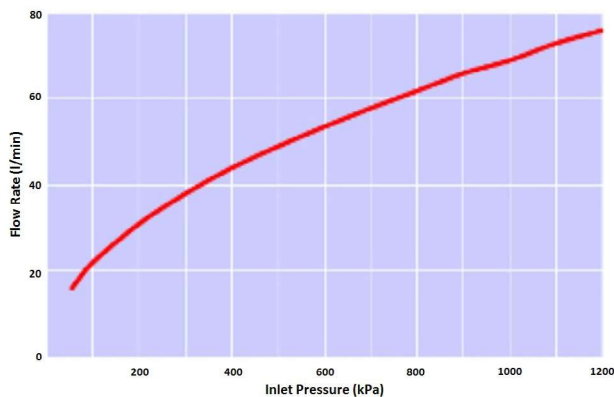

Specifications

- Inlet: 20mm (3/4") BSP male thread.
- Cold mains pressure water connection.
- Working pressure: 55-1200kPa (8-175 psi).
- Maximum water temperature: 60°C.
- Minimum water temperature: 1°C.
- Supplied with inlet strainer.

Standards & Approvals

- NZ Patent 535912.
- Australian Patent 736446.
- Australian Class II Patent No. 1025211.
- RSA Patent No. 98/8777.
- WaterMark Approved.



Parts & Materials

Body	UV Stabilised Acetyl
Float	PE
Cord	Nylon
Pins & Screws	Stainless Steel
Diaphragm	NBR
Filter	316 Stainless Steel

Dimensions

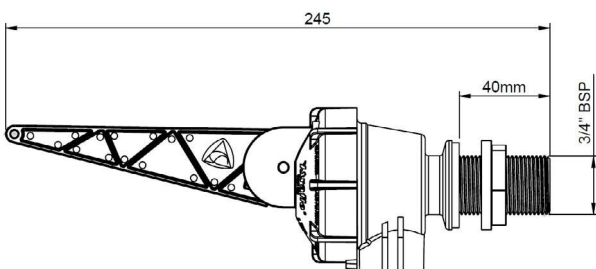

Video

Please click on the image to the right to view a video on the Apex RainAid® Valve or follow the link below:

https://youtu.be/J_YVwGRBsOK



Installation

- Valve must be installed horizontally.
- Do not install on an angle.
- Do not restrict inlet water flow.
- Not to be modified.
- Not to be used in dual purpose tanks that are used for storm water detention.
- Some Australian states stipulate a minimum water level that must be maintained for fire fighting purposes.
- Overflow and air gap to comply with local standards (air gap of 55mm complies with AS/NZS 3500.1).

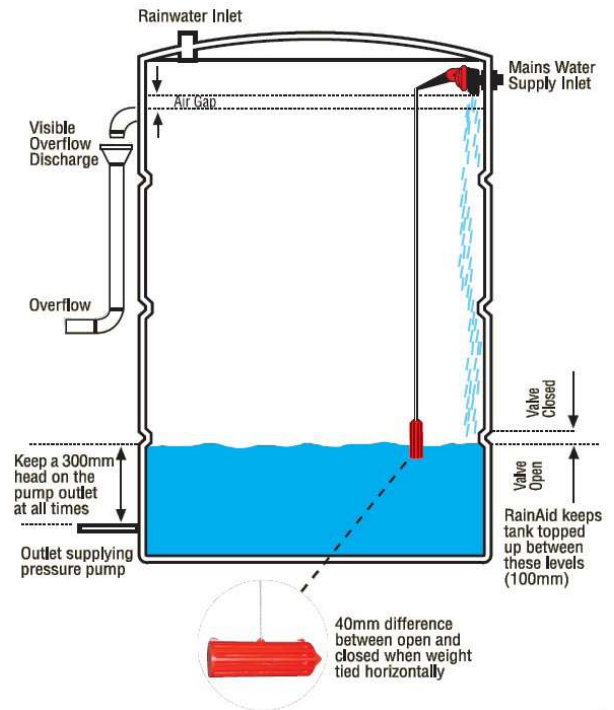

Range



APEX RainAid Valve

PART NUMBER	ITEM NUMBER	PRODUCT SIZE	THREAD
RA 20	08372112015	3/4"	LONG

Spare Parts

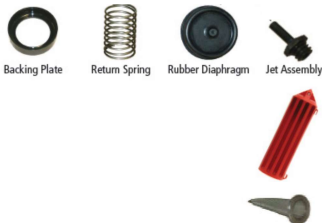

PART NO.	ITEM NUMBER	DESCRIPTION
RKRA	08372112020	RA REPAR KIT - BACKING PLATE, RETURN SPRING, RUBBER DIAPHRAGM & JET ASSEMBLY
P28RA	08372112030	RA FLOAT KIT - PLFRA WEIGHT & CORD
P7RA	08372112025	RA S/S FILTER - LTRASF STAINLESS STEEL FILTER

Customer Value through Innovation



NORMA Pacific Australia

74 Bazalgette Crescent
Dandenong South VIC 3175

Tel: 1300 252 677
Fax: 03 9761 4030

www.normagroup.com.au
sales.au@normagroup.com.au